



## Full Access Control Solutions

Technical Benefits and Training Support by IMMOTEC SYSTEMS, INC.

# A PERFECT MATCH

High level integration with many powerful Open management components.

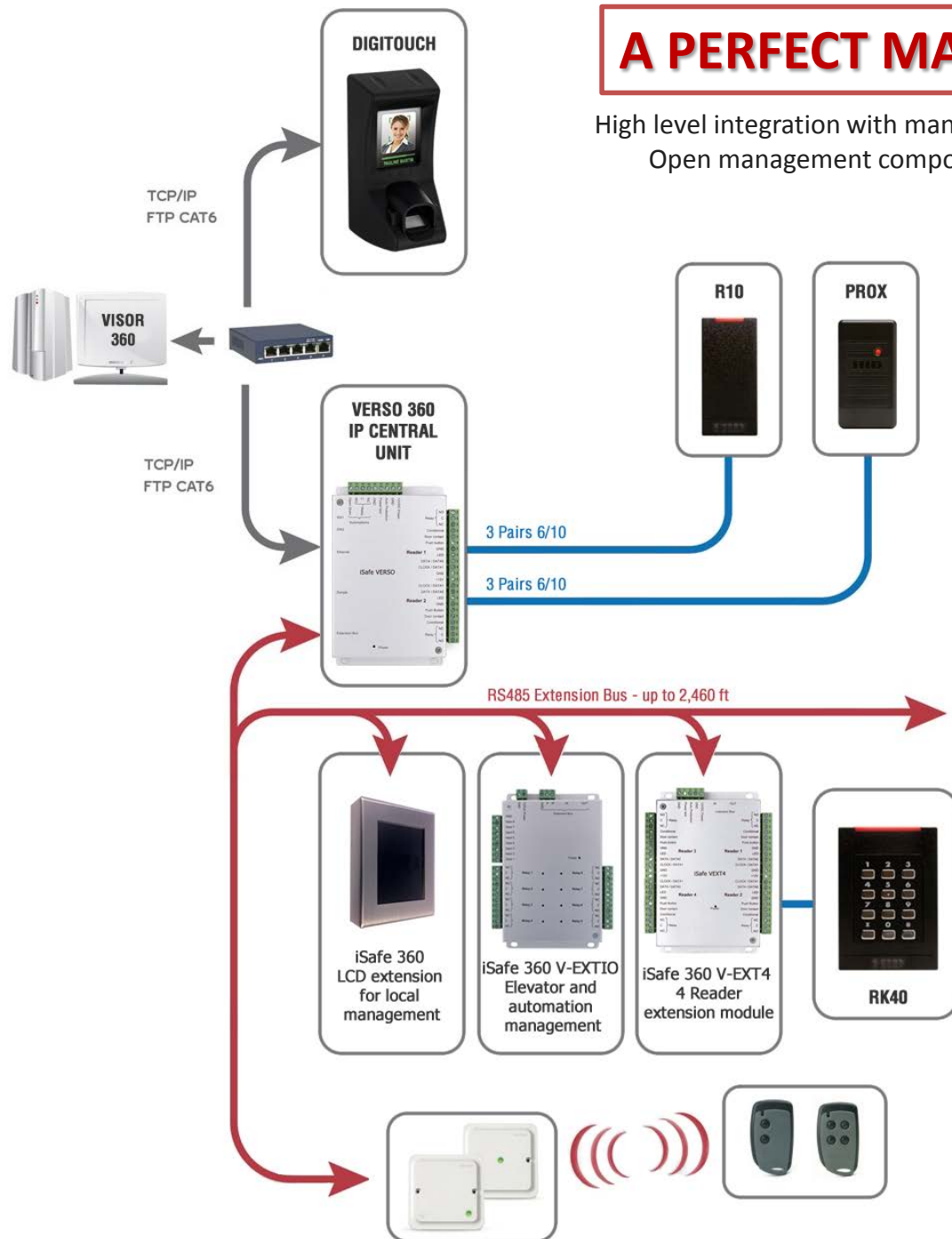

## iSafePro VISOR 360 Software

- ◆ 15,000 Identifiers
- ◆ Management of 1 to 840 access doors
- ◆ Supports all protocols
- ◆ Supports offline functionality
- ◆ Active mapping
- ◆ Compatibility: W7-XP-Vista
- ◆ Multi-Language
- ◆ Supports Access or SQL Server database
- ◆ Software Dongle for added security
- ◆ Random code management

[www.immotec.ca](http://www.immotec.ca)



## iSafe Pro Verso 360 IP Central Unit Capacity:

- **15,000 users per site:** The system makes a difference between a user and an identifier.
- **15,000 events memorized in each Verso 360 unit:** The events are stored within the unit's mobile flash memory.
- **Supports 1 to 840 readers:** Open concept management that allows to mix different protocols of badges within one installation.
- **128 time zones:** The time zone feature allows you to import Bank Holidays from Outlook in one click.
- **64 automations per Verso 360 unit:** A huge panel of automation! Everything becomes possible! A smart function that is easy to program.

Immotec's approach marks the beginning of a new era for access control  
It is becoming SIMPLE, FUNCTIONAL and ever more RELIABLE



iSafe V-EXT-4  
4 Door controller



iSafe Verso 360  
TCP IP 2-door main controller

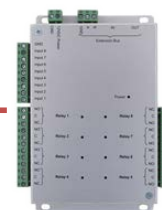

iSafe V-EXTIO  
8 Relay / Lift controller, customisable  
time schedule per floor/Relay

## iSafe Pro Verso 360 IP Central Unit Useful Aspects:

- **2 Readers:** The isafe Pro Verso 360 is not only the central IP unit but also acts as a 2 door controller.
- **Removable connectors:** large size up to 3mm, we want to make the products easy to install.
- **Glass fuse**
- **3 Relays 1A/12V and 1A/24V:** 2 for readers and 1 for automation.
- **Removable flash Memory:** To improve security of data.

Immotec's approach marks the beginning of a new era for access control  
It is becoming SIMPLE, FUNCTIONAL and ever more RELIABLE



iSafe V-EXT-4  
4 Door controller



iSafe Verso 360  
TCP IP 2-door main controller



iSafe V-EXTIO  
8 Relay / Lift controller, customisable  
time schedule per floor/Relay



## iSafe Pro Verso 360 IP Central Unit Remarkable Aspects:

- **IP Address integrated into the module:** Auto-detection of the IP address.
- **Dual-processor with redundancy function:** The system becomes extremely reliable thanks to this option.
- **Opto-isolation:** to protect the RS485 bus from high voltage current.
- **All protocols accepted:** huge flexibility of installation integrating old and new types of readers.
- **Security dongle:** To improve security of your hardware and data.

Immotec's approach marks the beginning of a new era for access control  
It is becoming SIMPLE, FUNCTIONAL and ever more RELIABLE



iSafe V-EXT-4  
4 Door controller



iSafe Verso 360  
TCP IP 2-door main controller



iSafe V-EXTIO  
8 Relay / Lift controller, customisable  
time schedule per floor/Relay

# GLOBAL SYSTEM ARCHITECTURE

iSafe wired system installation synoptic

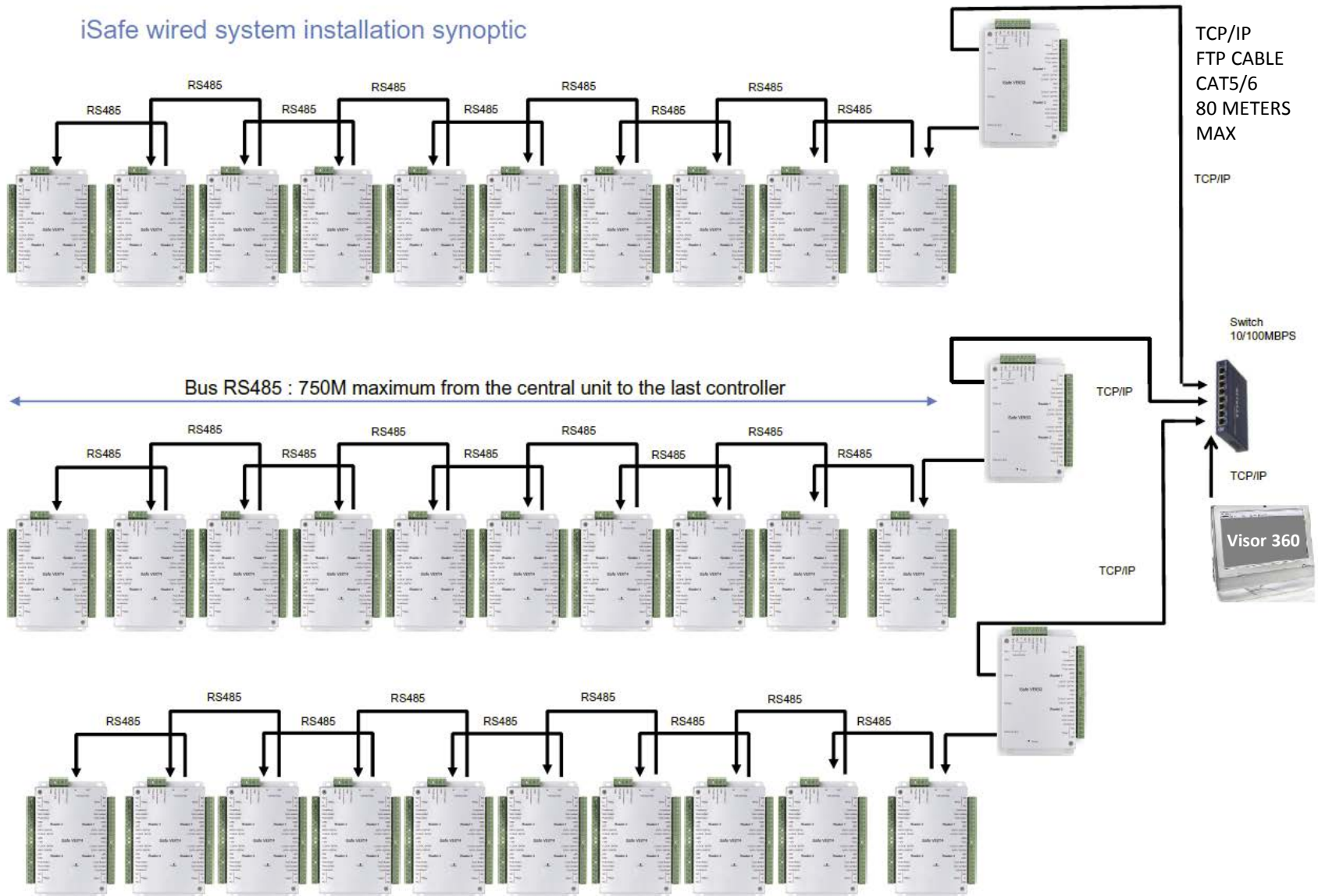

## iSafe Pro 360 V-EXT-4 Extension Module Description:

- **4 Downgraded Modes:** Very useful function in case RS485 bus is cut down.
- **4 Input no/nc**
- **4 relays 1A/12V**
- **Up to 10 V-EXT-4 Modules per iSafe Verso 360 IP module:** up to 40 readers behind one iSafe Verso 360!
- **2,460 ft Extension cable length with RS485 bus**
- **19200bps Uploading speed for data:** One of the most important aspect for the end user when the Network Server start again after an IP failure, to be sure that data is coming up with a very high speed.

Immotec's approach marks the beginning of a new era for access control  
It is becoming SIMPLE, FUNCTIONAL and ever more RELIABLE



iSafe V-EXT-4  
4 Door controller



iSafe Verso 360  
TCP IP 2-door main controller



iSafe V-EXTIO  
8 Relay / Lift controller, customisable  
time schedule per floor/Relay

## iSafe Pro 360 V-EXTIO Extension Module Application:

- **8 Relays 3A/12V and 3A/24V**
- **Main Application:** Elevator access control (8 floors per V-EXTIO Module) - Flexible and with Free access time zones that are programmable for each different floor.
- **Secondary Application:** Intrusion
- **Analog input**
- **Can be used in 2-state or 4-state (balanced loop) mode independently:** Very useful for door supervision

Immotec's approach marks the beginning of a new era for access control  
It is becoming SIMPLE, FUNCTIONAL and ever more RELIABLE



iSafe V-EXT-4  
4 Door controller



iSafe Verso 360  
TCP IP 2-door main controller



iSafe V-EXTIO  
8 Relay / Lift controller, customisable  
time schedule per floor/Relay



# WIRING INSTRUCTIONS

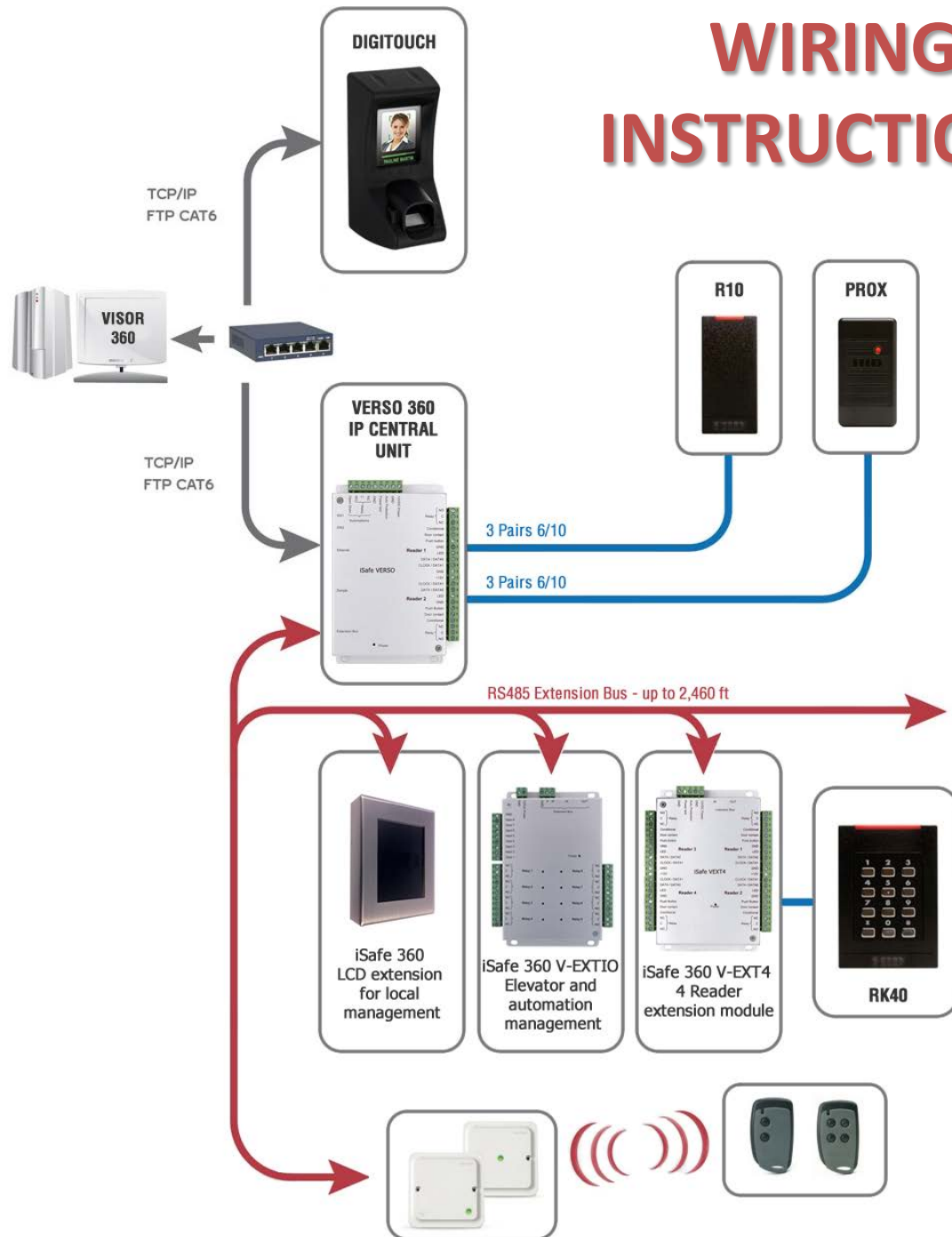

## iSafePro VISOR 360 Software

- ◆ 15,000 Identifiers
- ◆ Management of 1 to 840 access doors
- ◆ Supports all protocols
- ◆ Supports offline functionality
- ◆ Active mapping
- ◆ Compatibility: W7-XP-Vista
- ◆ Multi-Language
- ◆ Supports Access or SQL Server database
- ◆ Software Dongle for added security
- ◆ Random code management

[www.immotec.ca](http://www.immotec.ca)



## **APERIO Extension - A real time Wireless Access Control for interior doors**

- **Wireless Assa Abloy Electronic locks and Cylinders**
- **Full integration with our iSafe Pro 360 Solution**
- **Full centralized mode with real time monitoring**
- **Radio Hub managing from 1 to 8 wireless locks and cylinders within a maximum of 25 meters range**
- **10 wireless locks per iSafe Pro Verso 360 IP module**
- **Programmable Free-access time zones**

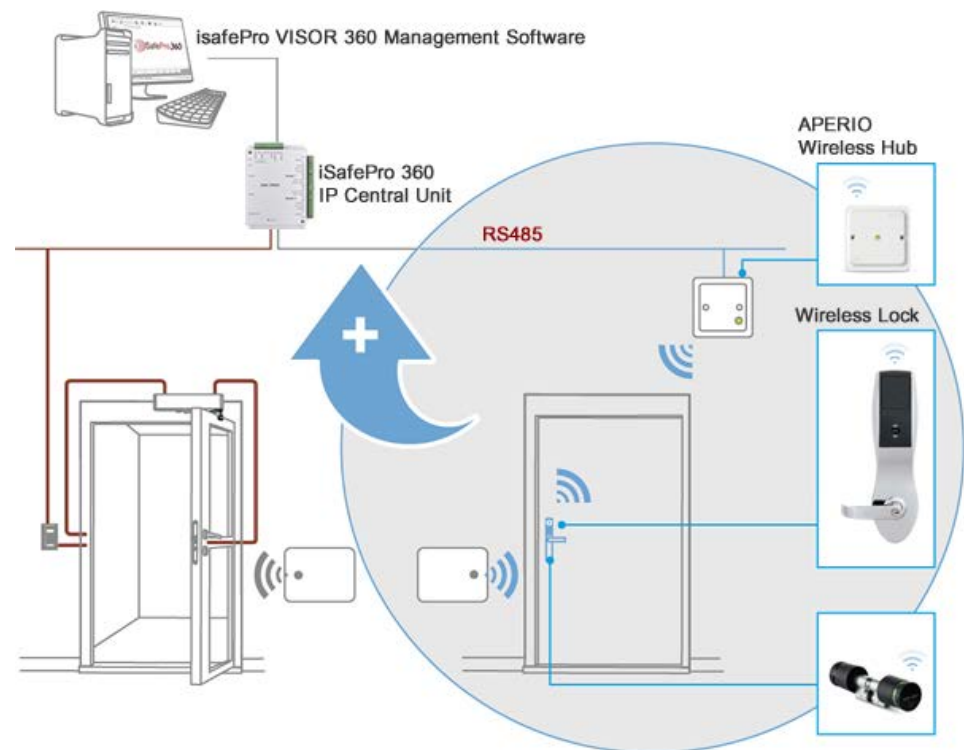

# APERIO – Wireless possibilities for online access control

## Full integration with our isafe Pro 360 Solution

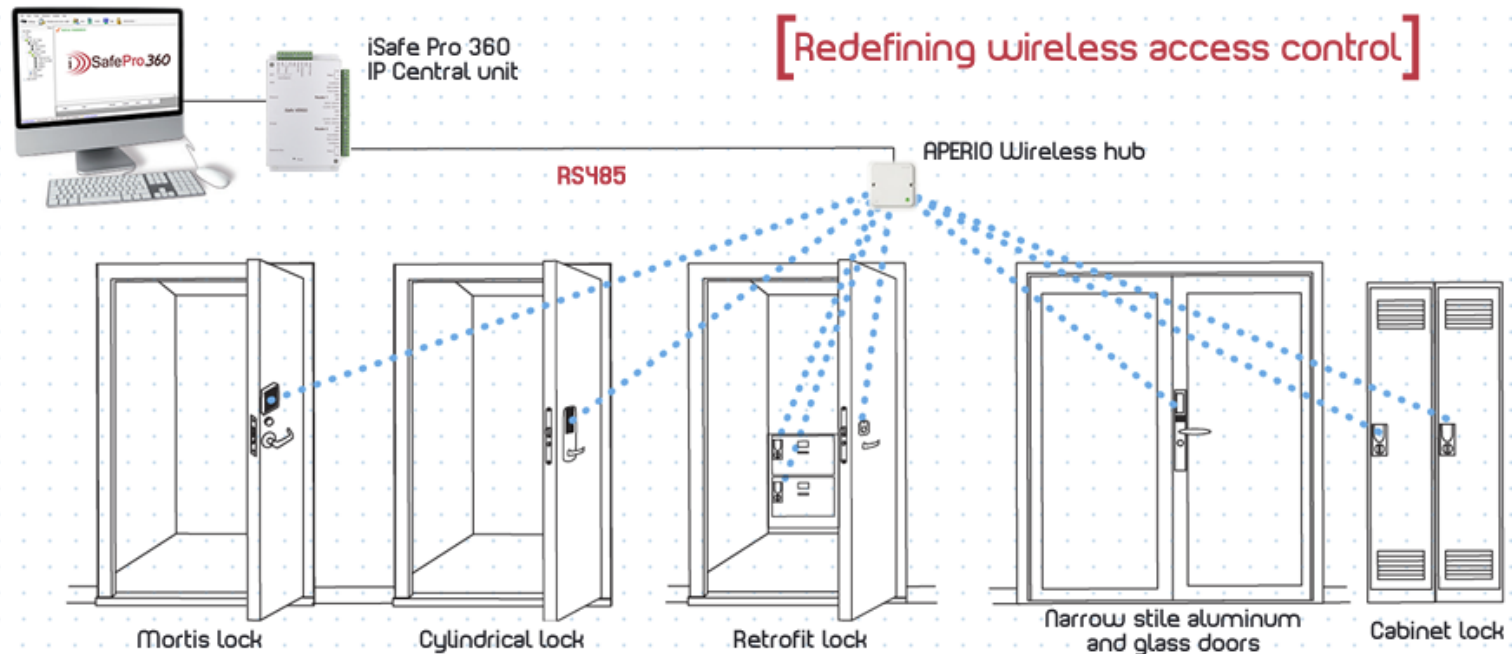

APERIO®  
ASSA ABLOY



PR100 Wireless  
Cylindrical lock



IN100 Wireless  
Mortis lock



M100 Wireless  
Retrofit solution  
Mortis cylinder



H100 Wireless  
Cabinet lock

## Digitouch - High Security Biometric Reader

- Biometric IP Reader (interior/exterior) (IP54)
- TCP/IP connection with RS485 extension
- Color touch screen – 4 Operational modes: Card only / code only / fingerprint only / fingerprint written into the access card
- Color Picture coming up for an accepted user

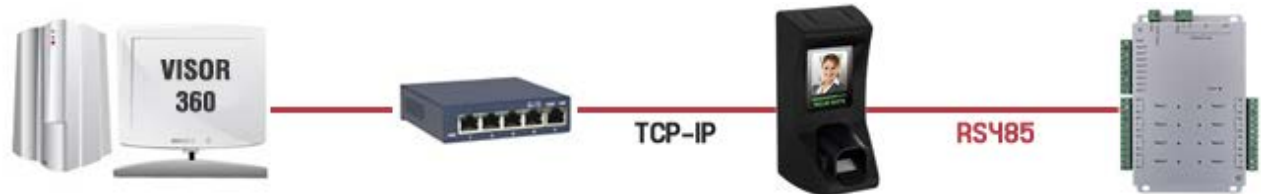

## Digitouch - Capacity

- Possibility to select « centralized mode or standalone mode »
- 15,000 users operating with their Finger Print located into a Badge and 500 users operating with Finger Print only.
- 15,000 events memorized into the unit's internal memory
- Programmable through Visor 360 (centralized mode)
- SD card or USB wiring for saving and backup program data



# **VISOR 360 SOFTWARE**

## **Useful Aspects:**

- **Open Concept: Supports all protocols**
- **W7 – XP and Vista compatibility**
- **32 bits and 64 bits compatible**
- **3 languages : English, French and Spanish**
- **User assistance features**
- **Supports Access and SQL server databases**
- **Supports offline capabilities**



# VISOR 360 SOFTWARE

## Remarkable Aspects:

- Automatic detection of IP address
- Voice messages with High audio quality
- Self Learning of badges or identifiers
- Intuitive programing for automations
- Graphical and manual capture for time zones and special holiday periods
- Up to 10 hourly periods per day
- Bank Holidays upload from Outlook
- 8 special holidays period lists
- Distinction between a badge, a code and a radio transmitter
- 1 user can have several identifiers (badge, code, radio transmitter)
- Badge printing model application
- Active mapping



# VISOR 360 SOFTWARE

## Active Map Overview:

- Map overview for doors, readers, analog inputs, outputs, counters and Secondary maps
- Real time display
- Remote control

## Shortcuts functions:

- Intuitive programming
- Avoids heavy training actions
- Shortcuts functions allowing personalized menu to the end user



# References:

"I had a fantastic experience installing the iSafePro Verso 360 and expansion modules along with the Visor 360 at a large factory. The hardware was easy to wire up and install and the software was very easy to use and configuration was a breeze. I will be recommending this product in the future."

Mr. Jason Waschlik  
President and CEO, Fortress Security Inc.

"We have been dealing with IMMOTEC for a number of years and we appreciate the high level of service and the quality of the product supplied. We have supplied numerous projects with no complaints and no product related problems."

Mr. Mark Ettridge, CET  
President, Alldoor Supply Inc.

"We installed the iSafe access control system in several of our stores due to their ease of set up and configuration via the web. It is very convenient for the users to make changes locally or remotely. There is also no maintenance work required. In all, a very dependable system."

Mr. Herman Poon  
Administration Manager, T&T Supermarket Inc.

"It was great to be able to call you and receive immediate support for my question today. The system continues to work extremely well. I really appreciate all that you do for us here at the HNHB LHIN."

Mrs. Sheila Stirling  
Corporate Services Assistant, HNHB LHIN.

"The isafe Pro access control system is so reliable and easy to use; we want it in all of our buildings."

Mr. Dragan Babin  
Property Manager, Greenwin Inc.







Immotec systems, inc.  
5000 Yonge Street, Unit # 1901, Toronto, Ontario M2N 7E9  
Tel: 416-741-4555 E-mail: [info@immotec.ca](mailto:info@immotec.ca) URL: [www.immotec.ca](http://www.immotec.ca)